

INITIAL RECEIPT

United States Department of the Interior
Bureau of Land Management
 DIV OF LANDS, MINRLS & ENERGY
 ONE N CENTRAL AVE
 PHOENIX, AZ 85004 -4427
 Phone: 602-417-9200

Receipt

No: 4711636

Transaction #: 4836390	
Date of Transaction: 03/10/2020	
CUSTOMER:	
SCOTT BROWN 35040 N JAMAICA HOPE WAY SAN TAN VALLEY, AZ 85143-5009 US	

LINE #	QTY	DESCRIPTION	REMARKS	UNIT PRICE	TOTAL
1	1.00	LOCATABLE MINERALS / MINING CLAIMS-NEW, UNADJUD, ONE OR MORE AUTH NOS / NEW MINING CLAIM PROCESSING FEE CASES: AMC459477/\$20.00		- n/a -	20.00
2	1.00	LOCATABLE MINERALS / MINING CLAIMS-NEW, UNADJUD, ONE OR MORE AUTH NOS / NEW MINING CLAIMS LOCATION FEE CASES: AMC459477/\$40.00		- n/a -	40.00
3	1.00	LOCATABLE MINERALS / MINING CLAIMS-NEW, UNADJUD, ONE OR MORE AUTH NOS / NEW MINING CLAIMS MAINTENANCE FEE CASES: AMC459477/\$165.00		- n/a -	165.00
TOTAL:					\$225.00

PAYMENT INFORMATION			
NOTE: Items will appear on credit card statement as "Bureau of Land Mgmt CO".			
1	AMOUNT:	225.00	POSTMARKED: N/A
	TYPE:	CREDIT CARD	RECEIVED: 03/10/2020
	NAME:	BROWN, SCOTT 35040 N JAMAICA HOPE WAY SAN TAN VALLEY AZ 85143-5009 US	
	CARD NO:	XXXXXXXXXXXX5198	AUTH CODE: 115366
	NAME ON CARD:	DAVID C ROSS	
	SIGNATURE:		

ENTERED
MAR 16 2020
 BY: *[Signature]*

REMARKS

This receipt was generated by the automated BLM Collections and Billing System and is a paper representation of a portion of the official electronic record contained therein.

MAR 18 2020

CORRESPONDENCE

TRANSFERS

MAINTENANCE FEES
WAIVERS
POL/NOI

MISCELLANEOUS

**LOCATION NOTICES
AMENDMENTS
STATUS SHEET
GEO REPORT/MTP**

MINING CLAIM STATUS REPORT

Data Entered: _____

MTP Checked By: EG

GEO Checked By: EG

LEAD SERIAL NUMBER: AMC 459477 thru AMC —

NUMBER OF CLAIMS & TYPE:

LODE
 1 PLACER
 ASSOCIATION PLACER
 MILL SITE
 TUNNEL SITE

CHARGES:

Processing Fee @ \$20 = \$ 20
 Location Fee @ \$40 = \$ 40
 Maintenance Fee @ \$165 = \$ 165
 Add'l Maint Fee for Assoc Placer = \$ _____
SUBTOTAL \$ 225
 Other Fees \$ _____
 Other Fees \$ _____
TOTAL \$ _____

TOTAL ACREAGE: 20. Per Claim
(Placer Only)

NUMBER OF LOCATORS: 2

DOCUMENTS RECEIVED VIA: Over-the-Counter Mail TIMELY FILED: Yes No

LEGAL DESCRIPTION: T IN R 11E SEC 35
 T _____ R _____ SEC _____
 T _____ R _____ SEC _____
 T _____ R _____ SEC _____
 T _____ R _____ SEC _____

BLM FOREST SERVICE TONTO SUBJ TO PL 359: Yes No
 WILDERNESS AREA _____

SPLIT ESTATE: N/A SX PX OTHER
 SRHA Was proper Notice filed if located on SHRA Land? Yes No

RECONVEYED MINERALS ON BLM LAND REQUIRE OPENING ORDER FROM 1944 TO 1993:
 Open to Entry On _____ N/A

COMMENTS/STATUS: VOID PARTIALLY VOID PVT MINERALS WITHDRAWN LANDS
 OTHER _____

[] Claimant acknowledges that portions of the following claim(s) site(s) may be void or voidable.

Printed Name of Claimant _____ Signature of Claimant _____

*****FINAL ADJUDICATION*****

DATE _____ INITIALS _____

459477

LOCATION NOTICE FOR PLACER MINING CLAIM

Amendment BLM Serial # _____

NOTICE IS HEREBY GIVEN that the Crooked Knee
_____ placer mining claim has been located by
Scott A. Brown & David C. Ross whose current mailing
address is Scott Brown: 35040 N. Jamaica Hope Way, San Tan Valley
AZ 85143 Dave Ross: 1820 E. Mahoney, Mesa Az 85204

RECEIVED
BLM AZ STATE OFFICE
2020 MAR 10 A 10:43
PHOENIX, ARIZONA

BLM
Date
Stamp

The general course of this claim is Rectangular and it is situated in Pinal

County, Arizona. This claim is 1320 feet in length and 660 feet in width.

20 Total Claim Acreage. This claim runs from the location monument on which this location notice is posted at the SW corner of the claim approximately 660 feet in a Northerly direction to the North end line and 1320 feet in a Easterly direction to the East end line. This claim is marked by four monuments, one at each corner of the claim.

The location monument on which this notice is posted is situated within Section 35, Township 1 N, Range 11 E, Gila Salt River Base and Meridian, Arizona. This claim encompasses portions of the following legal subdivision(s) if located by legal subdivision or the following quarter section(s), section(s), Township(s) and Range(s) NE 1/2 of the NE 1/4 of the SW 1/4 of Section 35, Township 1 N., Range 11 E., Gila Salt River Base and Meridian, Arizona.

The locality of this claim with reference to some natural object or permanent monument and additional information (if any) concerning its locality are as follows: _____

_____ The above information is shown on the attached map.

DATED AND POSTED on the ground this 2nd day of Feburary, 20 20.

LOCATOR(s) AGENT

Print Name(s) Scott A. Brown David C. Ross

Signature(s) [Handwritten Signatures]

Form MCF102
Revised July 2014

AMC459477

MINING CLAIM MAP

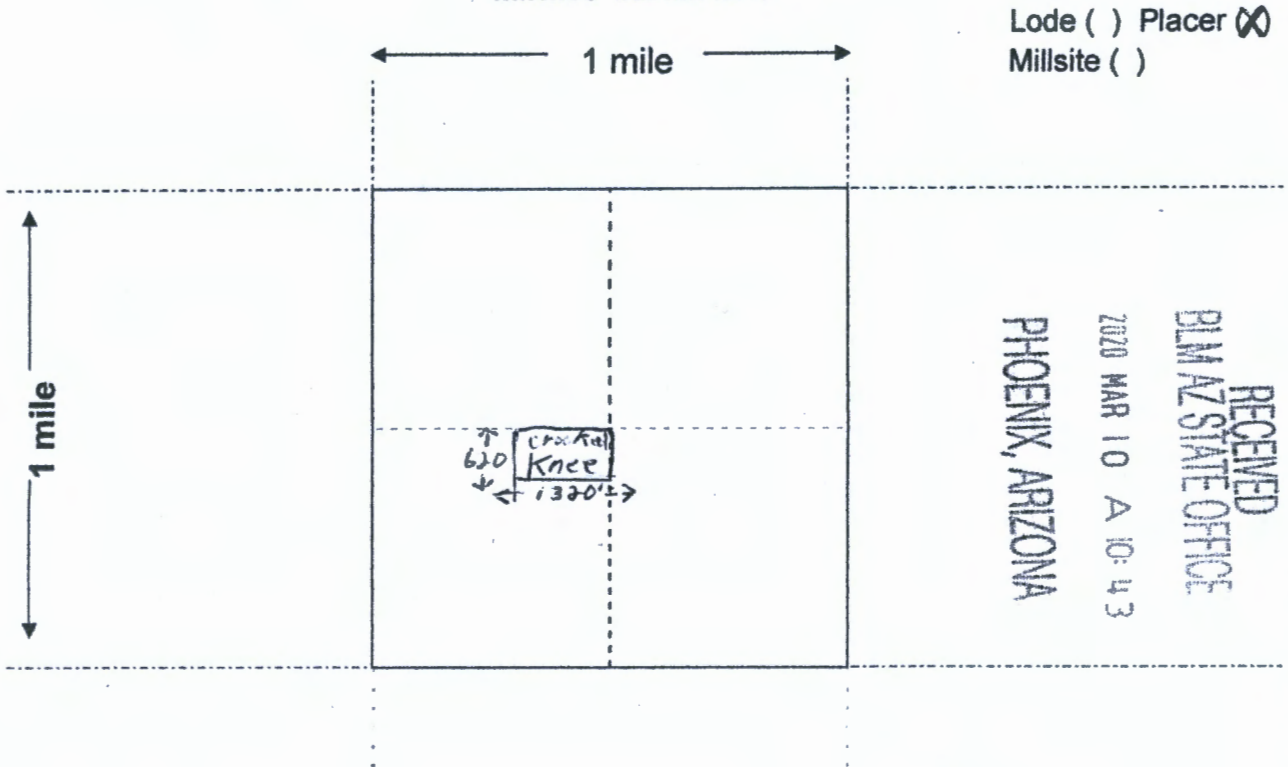

RECEIVED
BLM AZ STATE OFFICE
2020 MAR 10 A 10:43
PHOENIX, ARIZONA

AMC459477

Scale: 1" = 2000 feet



- The above map depicts the Crooked Knee mining claim, which is located in Section (s) 35, Township 1 N, Range 11 E, Gila and Salt River Base and Meridian, Pinal County, Arizona. Total claim acreage is 20
- The type of corner and location monuments used are as follows: 4' wooden Posts / metal name tag.
- The bearings and distances in degrees and feet between claim corners and to a public land survey monument are as depicted on the map.
- If the claim is a placer or millsite claim with exterior limits conforming to legal subdivisions of the public survey, provide a legal description of the claim NE 1/2 of the NE 1/4 of SW 1/4 of Section 35, T1N, R11E

Form MCF100a
Revised July 2014

▲ Purpose

This report produces a geographic listing of case information based on retrieval by Meridian/Township/Range. This report format will display the case type, case disposition, meridian, township, range, section, survey type, survey number, surface management agency, pending actions, serial number, and total case acres. The report produces listings of cases based on a combination of required and optional criteria.

Report



No Results

The specified criteria didn't result in any data. This is often caused by applying filters and/or selection steps that are too restrictive or that contain incorrect values. Please check your analysis filters and selection steps, and try again. The filters or selection steps currently being applied are shown below.

Filters

Case Suppression Flag is equal to / is in N
and Meridian Township Range Section is equal to 14 0010N 0110E 035
and Admin State is equal to AZ

[Return - Refresh](#)

